

GF30

GEAR PUMP FOR FILLING OF VISCOUS LIQUIDS



- 10 ml to more than 2 litres per fill
- Simple to use and easy to clean
- Filling parameters can be saved for different applications
- Optional pneumatic filling nozzles prevents dripping
- For tabletop applications or integration into automatic filling lines



Wide range of accessories



*GF30 without accessories -
accessories are sold separately*

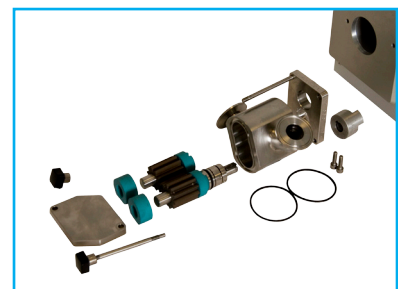

*Pump head is easy to take apart
for cleaning*

Watson-Marlow Flexicon

Frejasvej 2-6
DK-4100 Ringsted
Denmark
Tel. +45 57 67 11 55
Fax. +45 57 67 05 41
flexicon@flexicon.dk
www.wmflexicon.dk



GF30 TECHNICAL SPECIFICATIONS

GF30 handles creams and other liquids with a viscosity higher than water. The unit is the ideal solution to a demand for flexible filling within the cosmetics industry. The design fulfils the need for easy cleaning and programming.

It can be applied for tabletop filling applications or connected to an automatic bottle handling system.

Splashing and foaming can be prevented by a simple adjustment of the acceleration or the fill speed. Moreover, the reverse function of the pump as well as the build-in control for pneumatic filling nozzles will prevent dripping between each fill.

If the pressure generated in the fluid path is too high, a drain hole between the pump head and the cabinet prevents any liquid from getting along the shaft into the cabinet.

The GF30 can be connected to a product tank by means of a hose, sanitary connectors and clamps. Alternatively, when filling very viscous products a hopper can be mounted on top of the pump head.

A wide range of accessories are available for the GF30. For example, hose connectors in various sizes, pneumatic filling nozzles with inside or outside valves, separate filling stands, a foot pedal for manual activation, a hopper and pneumatic diving nozzle system can be supplied.

Fill speed in the range of 850 ml to 12.0000 ml per minute will depend on the fill volume and the viscosity to be filled.

Filling volume:
10 ml to more than 2 litres

Accuracy:
Better than +/-1%, depending on the viscosity

Flow:
850 to 12,000 ml/min., depending on the viscosity

Pump head:

- Housing made of AISI316
- Gears in Teflon coated AISI316
- Teflon bearings

Temperature of liquids during filling:
Max. 65 degrees Celsius (Standard configuration)

Mains:
110/240 VAC

Power consumption:
Max. 350 W

Enclosure:
Anodised aluminium and stainless steel

Ingress protection:
IP31

Weight:
22,5 kg

Interface:

- Input for start
- Open collector output for status (busy/not busy)
- RS232 for printer

Accessories:
Filling nozzles, filling stand, foot switch, feed hopper, diving nozzle system etc.

Dimensions in mm/inch

